

SITE DATA: RESIDENTIAL FOURTH DENSITY (R4) ZONE

PROPOSED ZONED USE	REQ'D./ MAX./ MIN.	PROPOSED
RESIDENTIAL	RESIDENTIAL	TWO 4 STOREY APARTMENTS
LOT AREA (MIN.): 200 SQ. M / UNIT FOR THE FIRST 4 UNITS, PLUS 100 SQ. M FOR EACH ADDITIONAL UNIT THEREAFTER UP TO A MAX. DENSITY OF 90 UNITS / GROSS HA.	12,800 SQ. M REQ'D FOR 124 UNITS (90 UNITS MAX.)	10,308 ± SQ. M 124 UNITS TOTAL (62 UNITS / BUILDING)
LOT FRONTAGE (MIN.)	30 M	100 M
FRONT SIDE YARD DEPTH (MIN.)	4.5 M	23.4 M
INTERIOR SIDE YARD DEPTH (MIN.)	7 M	7.11 M
REAR YARD DEPTH (MIN.)	7.5 M	7.7 M
LOT COVERAGE (MAX.)	35%	28%
BUILDING HEIGHT (MAX.)	15 M	14 M
LANDSCAPED OPEN SPACE (MIN.)	30%	32%
PARKING (MIN.): 1 SPACE / DWELLING UNIT; PLUS 1 SPACE FOR EVERY 4 DWELLING UNITS, OR FRACTION THEREOF, TO BE SET ASIDE FOR VISITOR PARKING	155	136
BICYCLE PARKING: 10% OF REQ'D VEHICLE PARKING	15	16

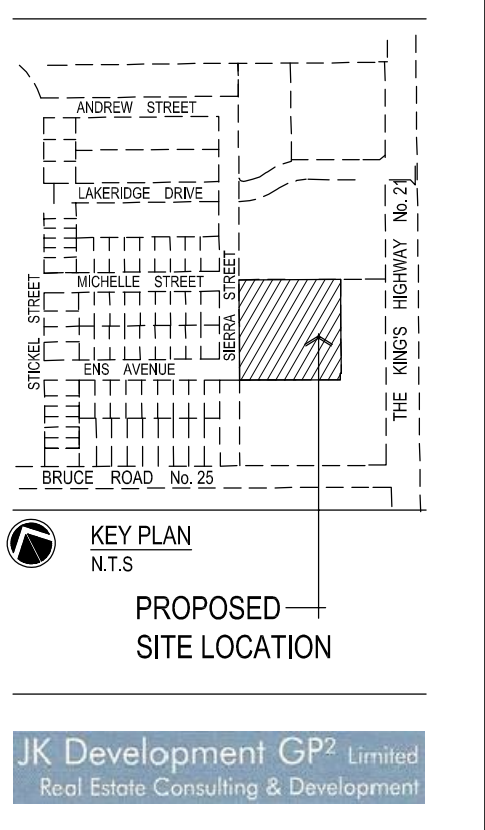

C2
A100 **SITE DATA**
Scale: N.T.S.

SITE LEGEND

- ▲ MAIN ENTRANCE
- △ SECONDARY ENTRANCE / EXIT
- ♿ BARRIER FREE PARKING SYMBOL
- ← VEHICULAR DIRECTION ARROW
- ▨ BARRIER FREE PATH OF TRAVEL PAVEMENT MARKING
- ⌵ SIAMOSE CONNECTION (WALL MOUNTED)
- ▨ FIRE ROUTE (CENTRE LINE)
- ▨ NEW FENCE
- ⊕ FH FIRE HYDRANT - REFER TO CIVIL DWGS
- ▨ NEW CONCRETE SIDEWALK (SWIRL BROOM FINISH)
- TREE (REFER TO LANDSCAPE PLAN)
- LS LIGHT STANDARD - REFER TO ELECT. DWGS
- ▨ FR# FIRE ROUTE (NO PARKING) SIGN TYPICAL

A2
A100 **SITE LEGEND**
Scale: N.T.S.

NO. DATE: ISSUED FOR: BY:

THE CONTRACTOR SHALL CHECK AND VERIFY ALL DIMENSIONS, FINISHES AND LEVELS PRIOR TO COMMENCEMENT OF WORK. ALL ERRORS AND OMISSIONS TO BE REPORTED TO THE ARCHITECT BEFORE PROCEEDING.

THIS DRAWING IS NOT TO BE SCALED FOR THE PURPOSE OF VERIFYING DIMENSIONS.

ALL DRAWINGS, SPECIFICATIONS AND RELATED DOCUMENTS ARE THE COPYRIGHT PROPERTY OF THE ARCHITECT AND MUST BE RETURNED TO THE ARCHITECT UPON COMPLETION OF THE PROJECT. REPRODUCTION OR TRANSMISSION OF ANY PART OF THIS DOCUMENT IN ANY FORM OR MANNER IS FORBIDDEN WITHOUT THE ARCHITECT'S WRITTEN PERMISSION.

THIS DRAWING IS NOT TO BE USED FOR BUILDING PURPOSES UNLESS APPROVED BY THE ARCHITECT.

SEAL:

matter.

Matter Architectural Studio Inc.
1108 Dundas Street, #300
London, Ontario, N6W 3A7
p: 519.601.6274
www.matterinc.ca

Project Title:
PORT ELGIN DEVELOPMENT

Sierra Street Port Elgin, ON.

Sheet Name:
SITE PLAN, SITE DATA

Scale: AS SHOWN Project No: 21-005
Sheet No: A100

A1
A100 **SITE PLAN**
Scale: 1:300